

COMPENSATING CLAMP ASSEMBLY

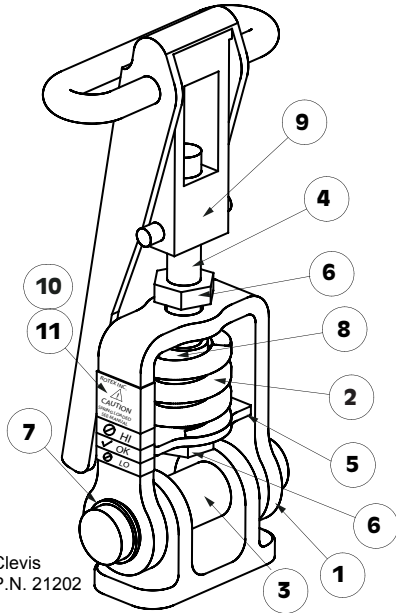

Clevis
P.N. 21202



Figure 1

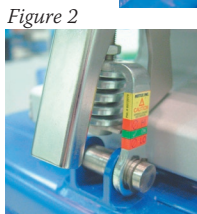

Figure 2



Figure 3

ASSEMBLY NO. (500 LB)	ASSEMBLY NO. (1000 LB)	ROD PART No.	LENGTH OF ROD
-	165103	66958	3 ½ in. (89mm)
162801	152307	67085	4 ½ in. (114mm)
162802	152308	67086	5 ½ in. (140mm)
162803	152309	67087	6 ½ in. (165mm)
162804	152310	65654	7 ½ in. (191mm)
162805	152312	67088	8 ½ in. (216mm)
162806	152313	64173	9 ½ in. (241mm)
162807	152314	67089	10 ½ in. (267mm)
162808	152315	67090	11 ½ in. (292mm)
162809	152316	67091	12 ½ in. (318mm)

ITEM	PART NO.	QTY.	DESCRIPTION
1	152290	1	Saddle Bracket
2	150799	1	Spring
3	150801	1	Hinge Pin
4	See Table above	1	Threaded Rod
5	150780	1	Indicator
6	155998	2	7/16 in. - 18 SS Thin Nut
7	122396	2	Snap Ring
8	152291	1	Bushing
9	21345	1	Clamp Handle Assembly
10	152295	1	Force Level Label (1000 lb)
11	161995	1	Force Level Label (500 lb)

CLAMPING PROCEDURE

- Fasten the clamp with an open hand to avoid pinching fingers (see figure 1). Be sure to check the compression – the indicator should be within the green OK area (see figure 2).
- If necessary, adjust by unclamping and turn the clamp handle on the threaded rod.
- Recheck all clamps for proper adjustment after they have been clamped.

UNCLAMPING PROCEDURE

- Firmly grasp the clamp handle and pull up on the bottom (see figure 3). Make sure to hold the clamp handle firmly to release the spring pressure slowly.

ASSEMBLY INSTRUCTIONS

Note: Apply Loctite® 242 thread locker to both nuts (6).

- Install the top nut (6) on the threaded rod (4).
- Install the indicator (5), bushing (8), spring (2) and saddle bracket (1) on the rod (4).
- Install the bottom nut so the threaded rod extends 1/16 in. (2mm) below.
- Tighten the top nut (6) until it contacts the top of the saddle bracket and then tighten the nut an additional one half turn to provide the proper spring preload.
- Apply the force level label (10\11) so the bottom edge of the label is flush with the bottom edge of the indicator.



CAUTION

Do not operate machine without all clamps installed and adjusted.