

**DRAG LINK ASSEMBLY 24128 (80 Series)**

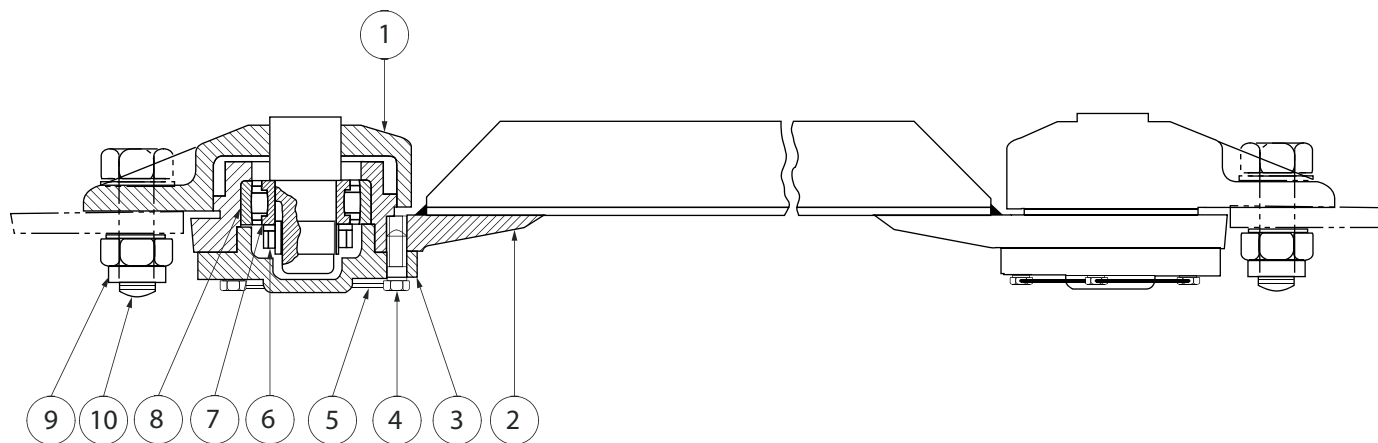

ITEM	PART NO.	QTY.	DESCRIPTION
1	24130	2	Bearing Spindle Assembly
2	24132	1	Connecting Arm Assembly
3	27340	2	Bearing Cap
4	9008	10	Cap Screw - HH $\frac{3}{8}$ in. NF x 1 in.
5	6408	2ft (60cm)	Brass Lock Wire
6	5973	2	Lock Nut - SKF N - 07
7	5974	2	Lock Washer - SKF W - 07
8	24133	2	Bearing
<i>The following are not part of the Drag Link Assembly.</i>			
9	94462	4	Lock Nut - HH - $\frac{7}{8}$ in. NC
10	91493	4	Cap Screw- HH - $\frac{7}{8}$ in. NC x $2 \frac{1}{4}$ in.

**MAINTENANCE INSTRUCTIONS**

**DISASSEMBLY**

1. Disconnect and lock out power to the machine.
2. Remove the drag link assembly from the box frame and base.
3. Place the assembly in a vise, so the bearing cap is up.
4. Remove the bearing cap.
5. Remove the lock nut and the lock washer from the bearing spindle in the connecting arm.
6. Push the bearing spindle assembly from the connecting arm.
7. Remove the bearing from the connecting arm.

**REASSEMBLY**

1. Press the bearing into the bearing housing.
2. Pack the connecting arm cavity with NLGI No. 2 extreme pressure multipurpose grease.
3. Push the bearing spindle assembly into bearing.
4. Install lock washer and lock nut on the bearing spindle and tighten.
5. Pack the bearing cap with NLGI No. 2 extreme pressure mutlipurpose grease.
6. Attach bearing cap with cap screws.
7. Install brass lock wire in drilled holes in cap screws.